

FEATURED MODEL

157-134-CR BLANCOMERIDIAN™ Bridge with side spray in Polished Chrome

ADDITIONAL MODELS

157-134-ST Stainless (Satin Nickel)

FEATURES

- Solid brass body
- Ceramic disc cartridge
- Color coded hot & cold supply lines
- Reversible mounting hardware adapts to thick or thin mounting surfaces
- 2.2 G.P.M. flow rate
- Installation in a 1-3/8" hole
- Side spray is cold-water use only

CODE/STANDARDS COMPLIANCE

ASME A112.18.1-2005
 IAPMO Listed

WARRANTY

Blanco America's Kitchen faucets feature a "NO HASSLE" LIMITED LIFETIME WARRANTY to be free of all manufacturing defects under normal use. See our complete warranty for details.

While Blanco America endeavors to provide accurate information, all dimensions are nominal, cannot be guaranteed, and are subject to change or cancellation. Blanco America assumes no responsibility for use of superseded or voided specifications.

PRODUCT SPECIFICATION

Kitchen faucet to include bridge design with cross handles with solid brass body, ceramic disc cartridge and cold-water only side spray. Faucet dimensions to be as follows: Reach: 9-1/2"; Spout Height: 9-1/4". Hot and cold supply lines to be color coded. Reversible mounting hardware to adapt to thick or thin mounting surfaces. Kitchen faucet to be BLANCOMERIDIAN™ Bridge with side spray, Model 157-134-_____ in _____ finish.

- Polished Chrome 157-134-CR
- Stainless (Satin Nickel) 157-134-ST



MODEL 157-134

NOMINAL DIMENSIONS

| MODEL | REACH | SPOUT HEIGHT | FAUCET HEIGHT |
|---------|-------|--------------|---------------|
| 157-134 | 9-1/2 | 9-1/4 | 15-15/16 |

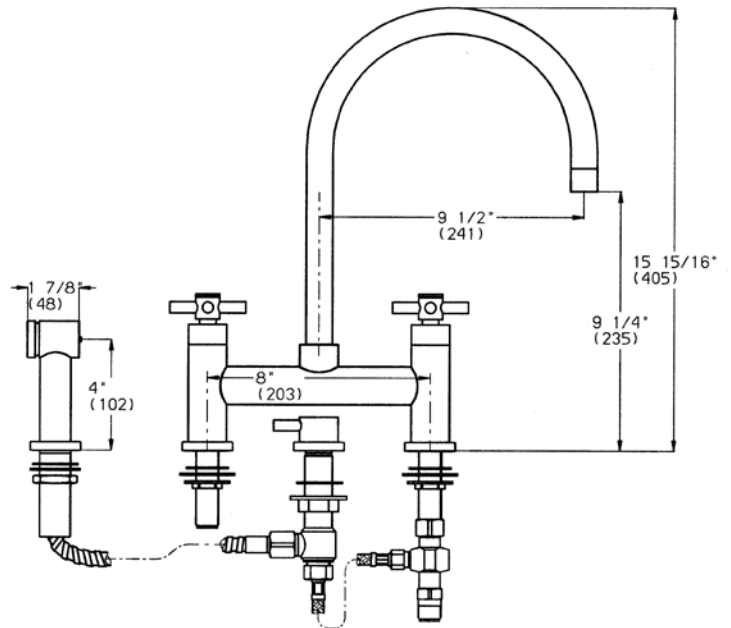

See next page for exploded parts drawing and parts list.

JOB INFORMATION

Job Name: _____

Contact: _____

Date Specified: _____

Specifier: _____

Contractor: _____

BLANCO AMERICA
800.451.5782
www.blancoamerica.com

BLANCOMERIDIAN™ BRIDGE MODEL 157-134

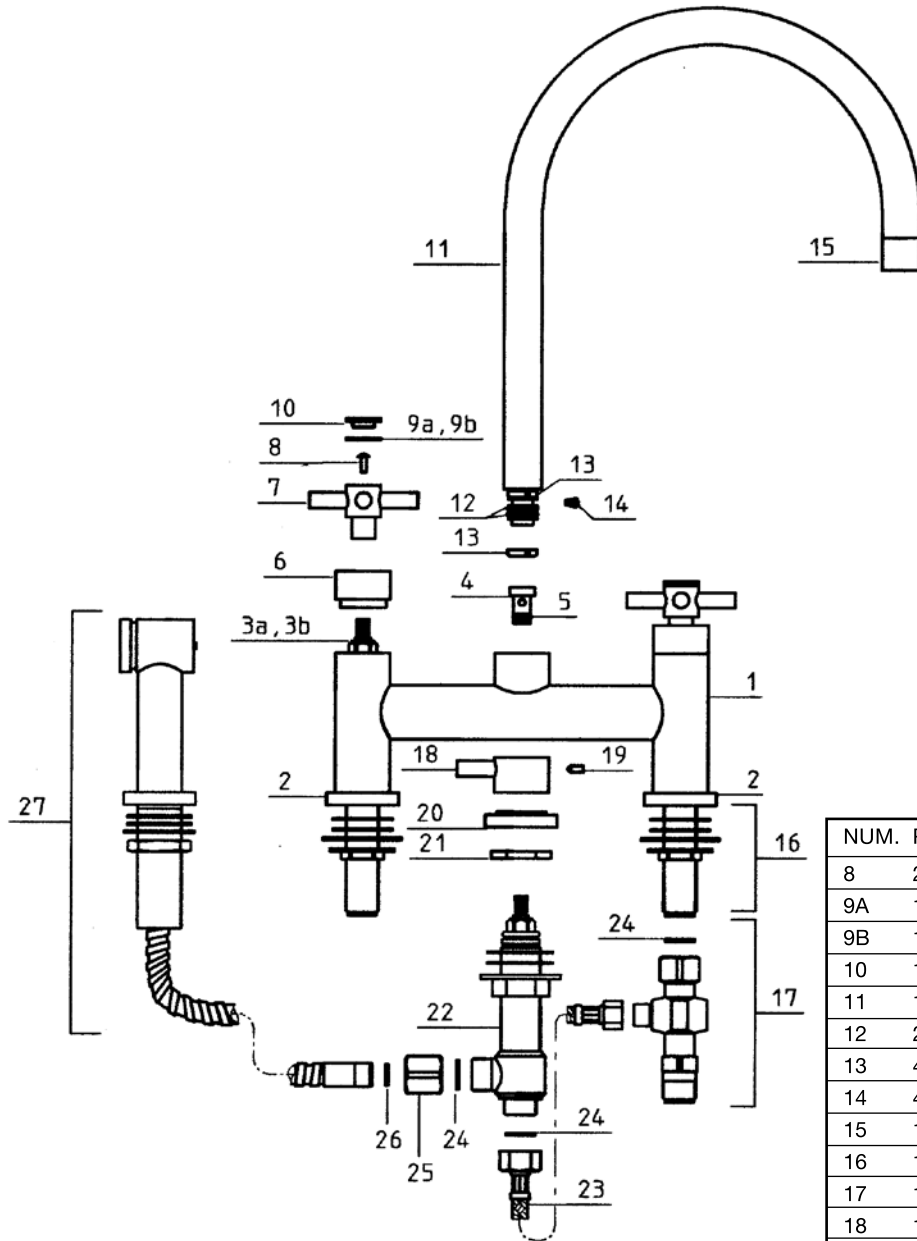

| NUM. | PART # | DESCRIPTION |
|------|-----------|-----------------|
| 1 | 4361 | BODY |
| 2 | 4362 | BASE |
| 3A | 315 | HEAD WORK LEFT |
| 3B | 2614 | HEAD WORK RIGHT |
| 4 | 4358 | PLUG |
| 5 | 3.53X4.34 | O-RING |
| 6 | 4363 | COVER |
| 7 | 1645 | LEVER |

| NUM. | PART # | DESCRIPTION |
|------|---------------|--------------------------------|
| 8 | 2312 | SCREW |
| 9A | 1648 | RED RING |
| 9B | 1649 | BLUE RING |
| 10 | 1647 | BUTTON |
| 11 | 1-4360 | SPOUT ASSY |
| 12 | 2.62X13.1 | O-RING |
| 13 | 4059 | TEFLON RING |
| 14 | 4058 | SCREW |
| 15 | 1-4359 | AERATOR SET |
| 16 | 1-853 | MOUNTING NUT ASSY |
| 17 | 1-4367 | CONNECTOR ASSY |
| 18 | 1-4350 | HANDLE ASSY |
| 19 | 3358 | SCREW |
| 20 | 4349 | BASE |
| 21 | 4348 | NUT |
| 22 | 3665 | COLD WATER SIDE SPRAY VALVE |
| 23 | 1028 | HOSE |
| 24 | 18.5X11.9X1.5 | FIBER WASHER |
| 25 | 4347 | NIPPLE |
| 26 | 13.7X10X1.5 | FIBER WASHER |
| 27 | 1-4355 | COLD WATER SIDE SPRAY |